



Zip HydroTap G5

Command Centre
Boiling, Boiling / Ambient models



AFFIX PRODUCT LABEL HERE



Australia



UK

Visit our website to
download the manuals

Table of contents

SECTION 1: Using these instructions	3
SECTION 2: IMPORTANT SAFETY INSTRUCTIONS.....	3
SECTION 3: WARNINGS & REGULATORY INFORMATION	6
SECTION 4: Technical data	8
SECTION 5: Parts supplied	9
SECTION 6: Set up the ventilation	10
SECTION 7: Connect the water supply	12
SECTION 8: Set the bypass & install the limescale filter	13
SECTION 9: Fit the Booster.....	14
SECTION 10: Connect the Booster	15
SECTION 11: Connect the Command Centre	16
SECTION 12: Commissioning	19

SECTION 1: Using these instructions

Before you start



This document is a Quick Start Installation Guide.
For further details on installing and operating your HydroTap, download & read the Command Centre installation and user instructions, which can be found online at:
(Australia) www.zipwater.com
(UK) specify.zipwater.co.uk



Read and use the instructions supplied with individual kit components for a safe installation.

Explanation of symbols



Read the instructions



WARNING



Danger of electric shock



Hot surface



Button/
coin battery

SECTION 2: IMPORTANT SAFETY INSTRUCTIONS



Compliance

In Australia electrical installation must comply with AS/NZS3000.

In Australia plumbing installation must comply with AS/NZS3500.

In the UK the system must be installed in accordance with water supply byelaws, current IEEE regulations and local authority byelaws.

Safety

This appliance is not intended for use by children under 8 years or persons (including children under 8 years) with reduced physical, sensory or mental capabilities, or lack of experience and knowledge, unless they have been given supervision or instruction concerning the use of the appliance by a person responsible for their safety. Children should be supervised to ensure that they do not play with the appliance.

Qualifications

To avoid hazards, all installation procedures must be carried out by a suitably qualified tradesperson. The power cable and power outlet must be in a safe visible position for connection.

Venting

Sometimes steam and / or boiling water droplets may discharge through a vent outlet on the tap. If not using the font, ensure the tap body is located so the tap outlet safely dispenses into the sink bowl.

Lifting

Take care when lifting. The Command Centre may exceed safe lifting limits.

If you feel this is beyond your personal capabilities, please seek assistance with the lift. The weight of the Command Centre is marked on the packaging. Do not lift the Command Centre by the front cover or any of its connections.

Airflow

The Zip HydroTap operates within the ambient temperature range 5°C - 35°C. Proper air circulation must be provided. The system will operate satisfactorily only if the recommended air gaps are provided. The vent kit supplied must be fitted.

Altitude

Water boils at varying temperatures at different altitudes. The HydroTap adjusts for this during startup calibration and will recalibrate itself on a regular basis.

Frost protection

If the HydroTap is located where the ambient air temperature could fall

SECTION 2: IMPORTANT SAFETY INSTRUCTIONS

below 5°C when the system is not in use, do not turn off the Command Centre electrically. This safeguard does not offer the same protection to the connecting pipework and fittings.

Application

The HydroTap G5 Home series is intended to be used in household and similar applications such as:

- Staff kitchen areas in shops, offices and other working environments;
- Farm houses and by clients in hotels, motels and other residential type environments;
- Bed and breakfast type environments;
- Catering and similar non-retail applications.



Compressed gas warning - HydroTap Clean can

- Read label before use.
- Keep out of reach of children.
- Use according to SDS (safety data sheet).
- Pressurised container. Contains gas under pressure, may explode if heated.
- Protect from sunlight.
- Do not expose to temperatures exceeding 50°C.
- Do not expose to naked flame or any incandescent material.
- Do not pierce or burn, even after use.
- Avoid shock.
- SDS is available for download at www.zipwater.com or www.zipwater.co.uk

First aid

- For advice contact a Poison Control Information Centre
- Australia (+61) 131126
- Ireland (+353) 1809 2166
- UK (+44) 171 635 9191

SECTION 3: WARNINGS & REGULATORY INFORMATION



- For continued safety of this appliance it must be installed, operated and maintained in accordance with the manufacturer's instructions.



- This appliance may deliver water at high temperature. Refer to the Plumbing Code of Australia (PCA), local requirements and installation instructions to determine if additional delivery temperature control is required.



- The button/coin battery is hazardous and is to be kept away from children. It can cause severe or fatal injuries in 2 hours or less if it is swallowed or placed inside any part of the body. Medical attention should be sought immediately if it is suspected the battery has been swallowed or placed inside any part of the body.



- The Zip HydroTap must be earthed. Earthing is provided via the supplied power cord. The resistance of the earth connection to each exposed metal part must be less than 1Ω. Use the power cable supplied. It is the responsibility of the installer to ensure the power point is earthed.
- All installation and service work must be completed by trained and suitably qualified tradespeople. Faulty operation due to unqualified persons working on this product may void warranty coverage.
- As the installer, it is your responsibility to supply and install all valves as required by local regulations and relevant standards.
- The HydroTap is rated for 220-240V 50Hz AC operation.
- Do not remove the cover of the appliance under any circumstances without first isolating the appliance from the power supply.
- Connect only to a potable (wholesome, cat1) mains water supply.
- The new hose sets supplied with the product must be used. Do not re-use old hose sets.
- Never locate the system near, or clean with water jets.
- Do not expose the Zip HydroTap to the elements of nature.
- The booster complies with protection class IP 20.

SECTION 3: WARNINGS & REGULATORY INFORMATION

- For UK, a pressure limiting valve must be fitted for mains water pressures above the maximum limits stated.
- Use of tools can be hazardous. Assess the risks before you start.
- A clearance envelope around all Command Centres must be provided to allow adequate ventilation for the safe and effective use of the HydroTap system.
- Valve and fitting threads must be sealed appropriately with PTFE tape where compression seals are not provided.
- Always flush new filter before use.
- Do not connect Booster to electrical supply until commissioning.
- Do not over tighten plumbing and hose connections.
- Braided hoses supplied cannot be lengthened.
- The power cord and general power outlet must be in a safe and accessible position after installation. When positioning the appliance, ensure the power supply cord is not trapped or damaged. If the power supply cord is damaged it must be replaced by a Zip service provider or a qualified electrician.
- Do not locate multiple portable socket-outlets or portable power supplies at the rear of the appliance.
- For safe operation, the HydroTap is designed to be installed, commissioned and used within 48 hours. Should the HydroTap not be required for an extended period of time (72 hours or more), do not fill and commission the HydroTap until ready for first use.
- For water taste and quality reasons, following any non-use period of more than 72 hours, Zip recommends to perform a system flush. Failure to flush the system may affect water quality.
- For UK, this appliance only contains materials that conform to the requirements of BS6920:2014 'Suitability of non metallic materials and products for use in contact with water intended for human consumption with regard to their effect on the quality of water'.

SECTION 4: Technical data

Component	Power rating kW	Dimensions W x D x H (mm)	Weight (kg)
B100, BA100	1.8 + Booster	280 x 313 x 333	13
B60, BA60	1.8	280 x 313 x 333	13
B, BA Home	1.35	280 x 313 x 333	13

Electricity supply requirements

220-240V 50Hz AC (for power requirement see table above).

Without booster		With booster
Australia	1x 220 - 240V AC 10A socket	2x 220 - 240V AC 10A sockets
UK	1x 220 - 240V AC 13A socket	2x 220 - 240V AC 13A sockets

Water supply pressure requirements

Component	Min - Max pressure, kPA (bar)	
	Australia	UK
HydroTap	170 (1.7) - 700 (7.0)	170 (1.7) - 500 (5.0)
Vented Mixer Tap	300 (3.0) - 700 (7.0)	200 (2.0) - 500 (5.0)
Booster	200 (2.0) - 700 (7.0)	200 (2.0) - 500 (5.0)
Limescale filter	200 (2.0) - 700 (7.0)	200 (2.0) - 500 (5.0)



A pressure limiting valve must be fitted for mains water pressures above the maximum limits stated above in accordance with local plumbing regulations.

Note: All models (excluding UK) have an internal pressure limiting device to reduce the maximum mains regulated pressure (700kPa in Australia), protecting the system against pressure surges above 500kPa.

Water supply connection

1/2" BSP (G1/2)

Booster specification

Specification	Rating
Power 230V 50/60Hz	2.20kW
Power 240V 50/60Hz	2.40kW
Flow rate	1.2 L/min

SECTION 5: Parts supplied

Parts supplied with the HydroTap	For Work	For Home
Tap		
HydroTap tap kit	✓	✓
Separate Mains mixer Tap kit	Optional	Optional
Command Centre		
Command Centre	✓	✓
Mains electrical supply cable	✓	✓
Water supply inlet hose	✓	✓
Water supply inlet adaptor and strainer	✓	✓
Ventilation kit	✓	✓
Water block kit	(UK only)	(UK only)
Booster		
Booster & hoses	Optional	✗
Filters		
Water filter & instructions	✓	✓
Limescale filter kit	Optional	Optional
Font		
Font kit	Optional	Optional

Note: Mains water isolation valve is not supplied with the kit.

Contact Zip for the full range of consumables and accessories.

SECTION 6: Set up the ventilation



A clearance envelope around all Command Centres must be provided to allow ventilation for the safe and effective use of the HydroTap system.

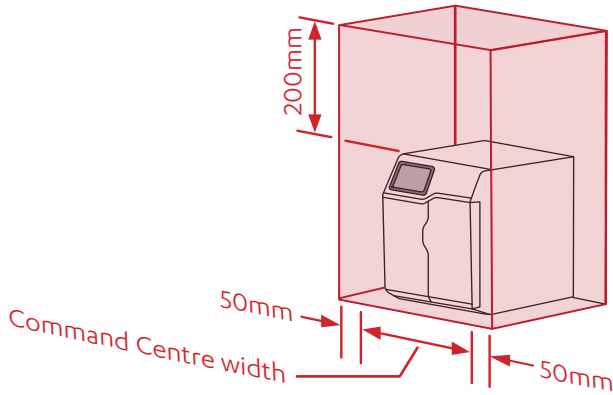

SECTION 6: Set up the ventilation

B60 - 100, BA60 - 100, B Home, BA Home models

- Cold air is drawn in through the inlet vent and lower gap provided by the door buffers.
- Warm air is exhausted through the upper gap provided by the door buffers.

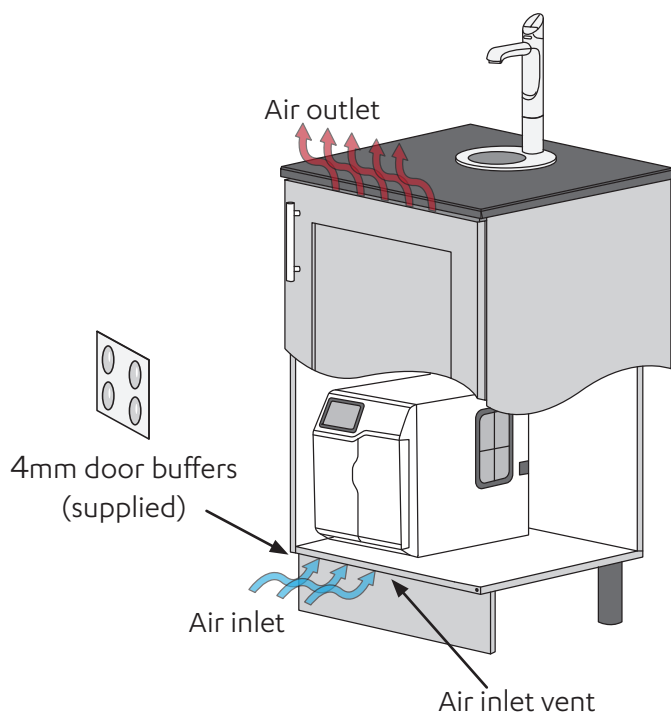

All models

If cupboard temperature exceeds 35°C, additional ventilation is required. Contact your Zip service provider for options (including additional vents and fan kit).

SECTION 7: Connect the water supply



Valves and fittings must be sealed with PTFE tape if compression seals are not included.

Note Mixer tap installations also use a 'Tee piece' as part of the water supply plumbing connections, see the Tap installation instructions supplied with the Mixer Tap to connect the water supply if using the mixer tap option.

Note correct strainer orientation.

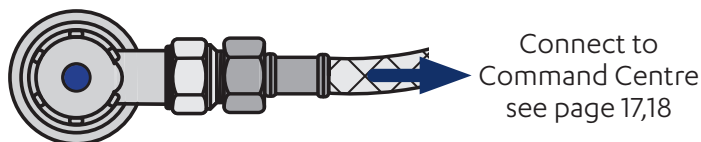
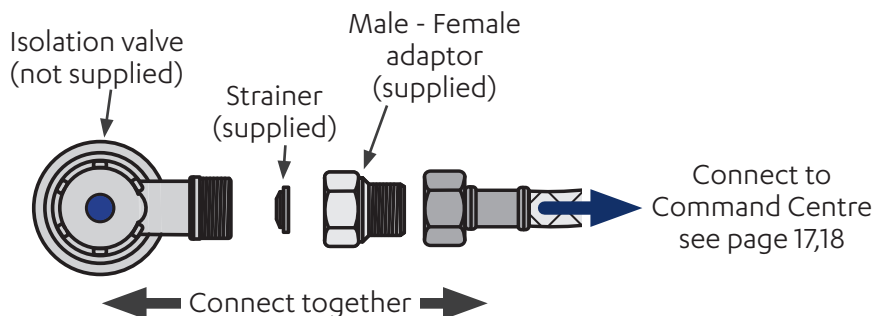

SECTION 8: Set the bypass & install the limescale filter

Available as optional accessory - UK only.



For filter head installation use the guide supplied with the filter head.

For Limescale filter installation use the guide supplied with the filter.



Flush filter before use.

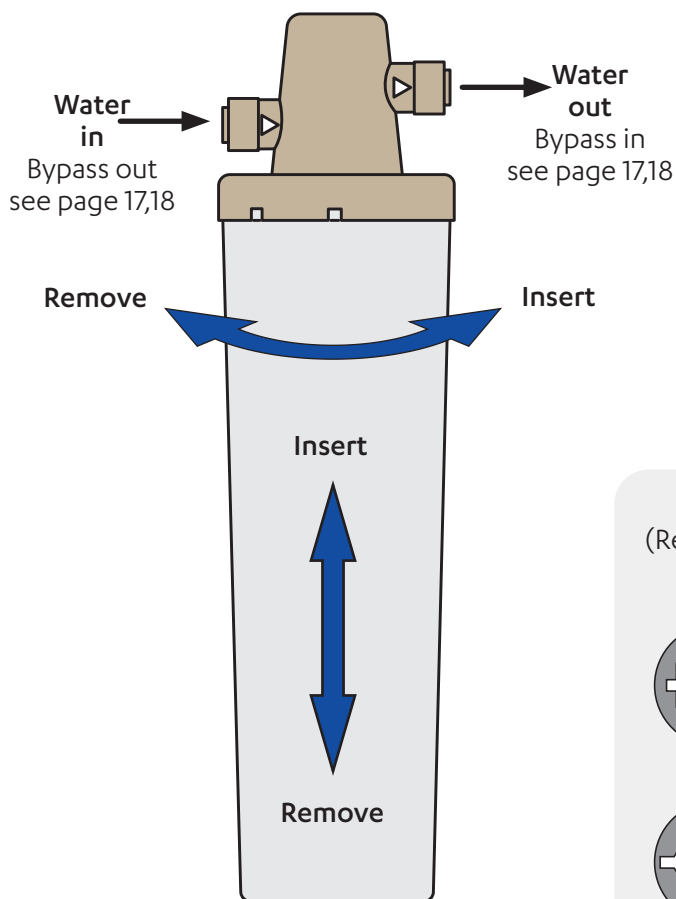

Bypass valve
(Rear of the Command Centre)

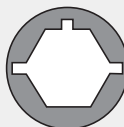

SECTION 9: Fit the Booster

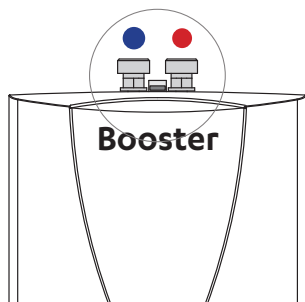

- Supplied with selected models, or available as an optional accessory.

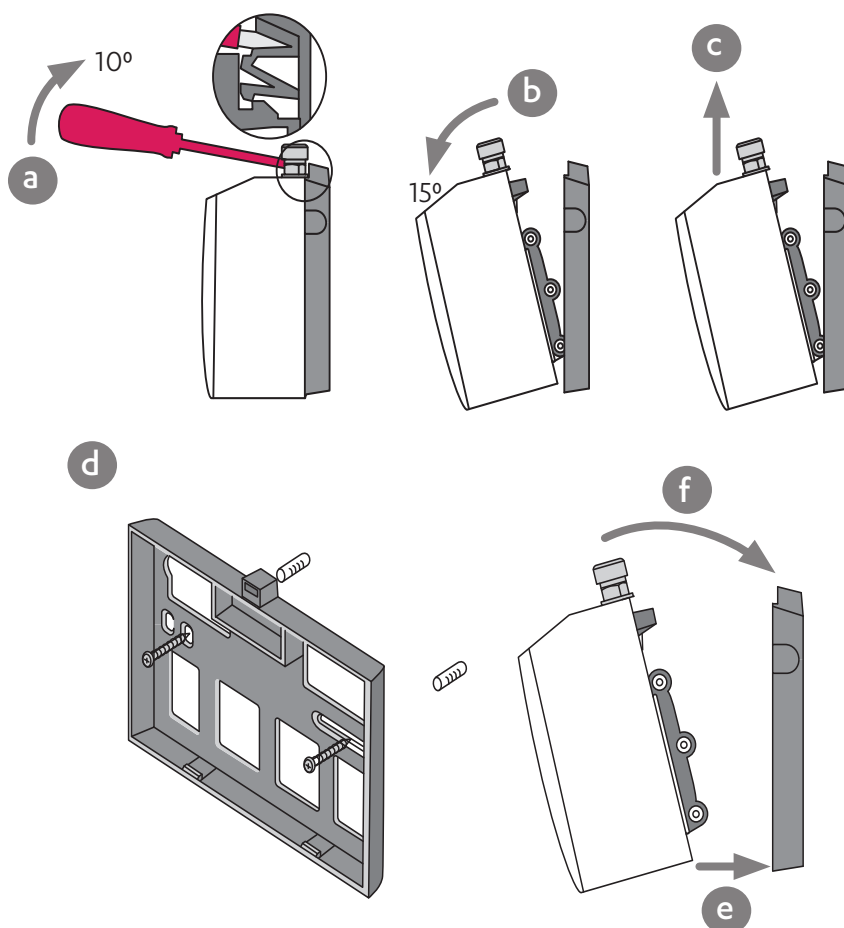

Note Take care not to break the clips when removing or installing the Booster.

SECTION 10: Connect the Booster

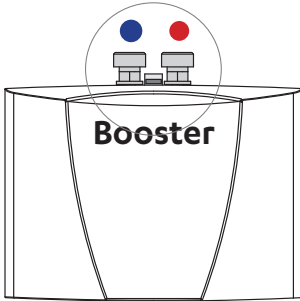

Do not connect to electrical power until commissioning.

Do not over tighten hose connections.

Braided hoses supplied cannot be lengthened.

Cold water into Booster,
connect to Command Centre

BYPASS OUT

see page 17,18

Hot water out of Booster,
connect to Command Centre

BYPASS IN

see page 17,18

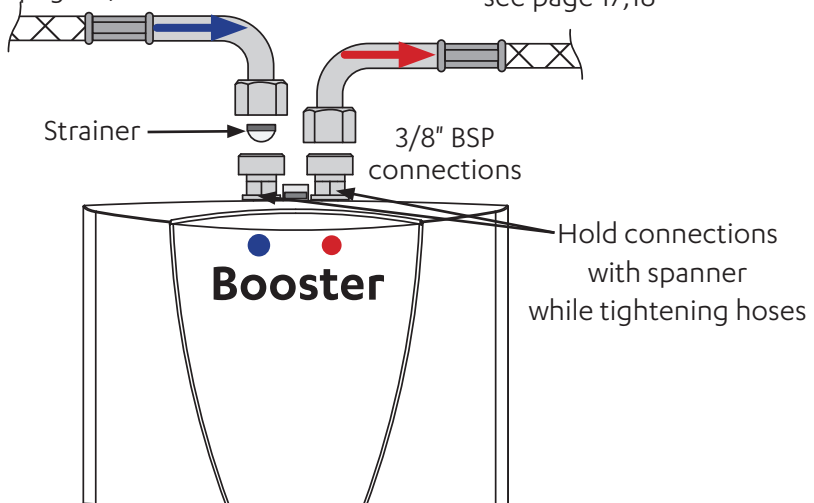

SECTION 11: Connect the Command Centre

Generic installation instructions



For HydroTap, mixer tap and any optional accessories, use instructions supplied with individual kit components.

Mains power cable

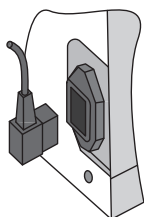

Do not connect to the mains socket until commissioning

USB

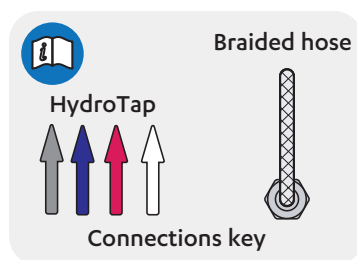
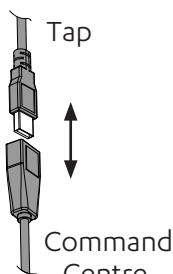

Installation diagrams are for illustrative purposes only.
Hoses are not shown to scale and cannot be lengthened.

Tips for hose connection

- Push the silicone hose over the connector for a minimum of 15mm.
- Ensure there is a constant fall from the tap down to the command centre.
- Hoses must be trimmed to avoid loops and kinks. Take care when positioning before cutting and make a clean cut straight across the hose, using a sharp blade.
- The hoses must not be under tension when installed.

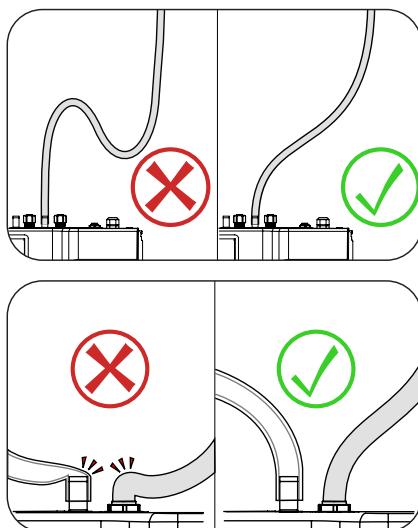

SECTION 11: Connect the Command Centre

B60, B100, B Home models

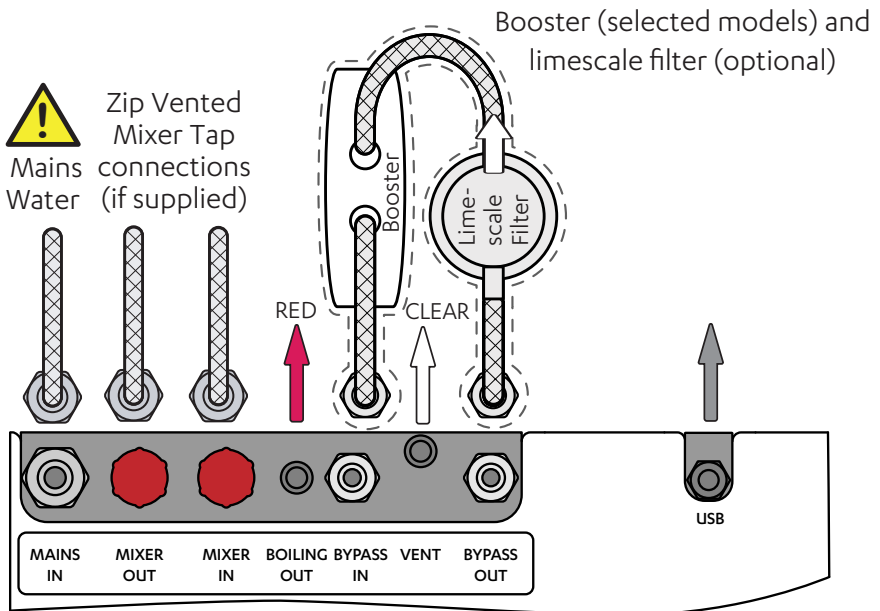

Example installation

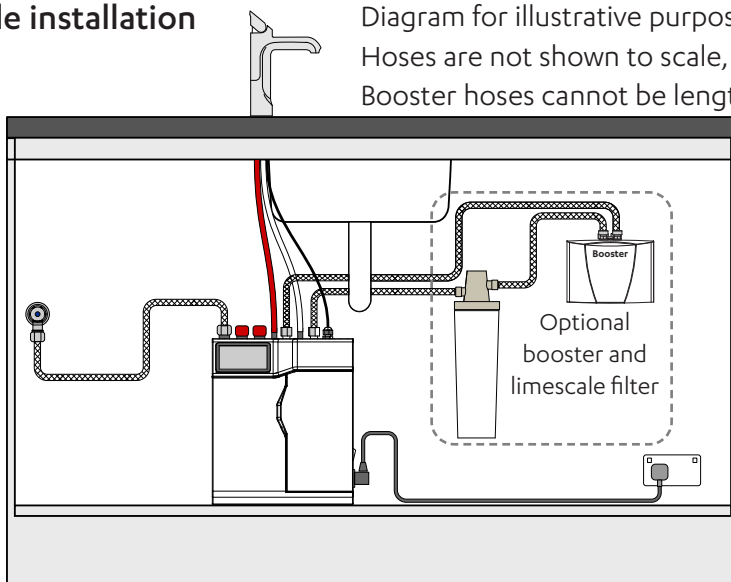

SECTION 11: Connect the Command Centre

BA60, BA100, BA Home models

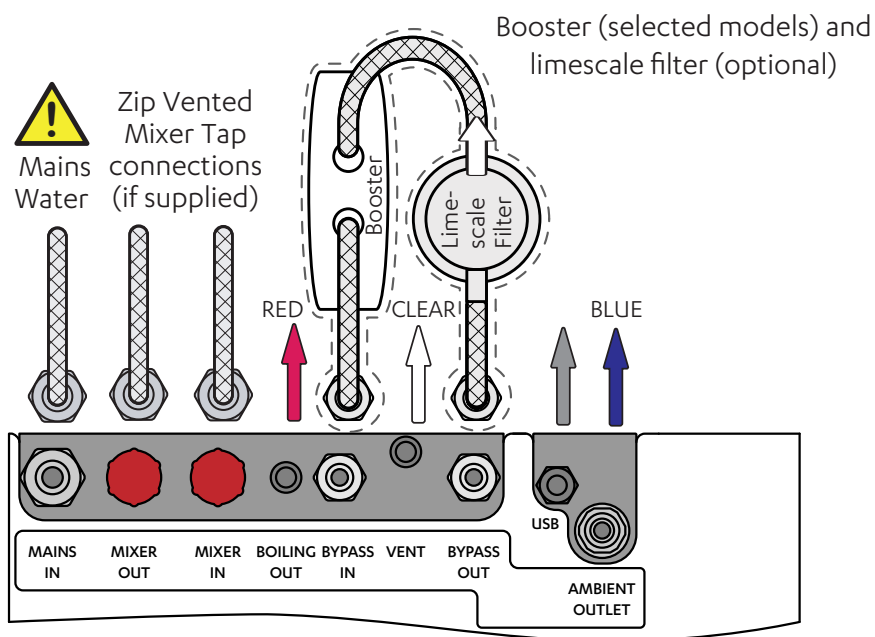

Example installation

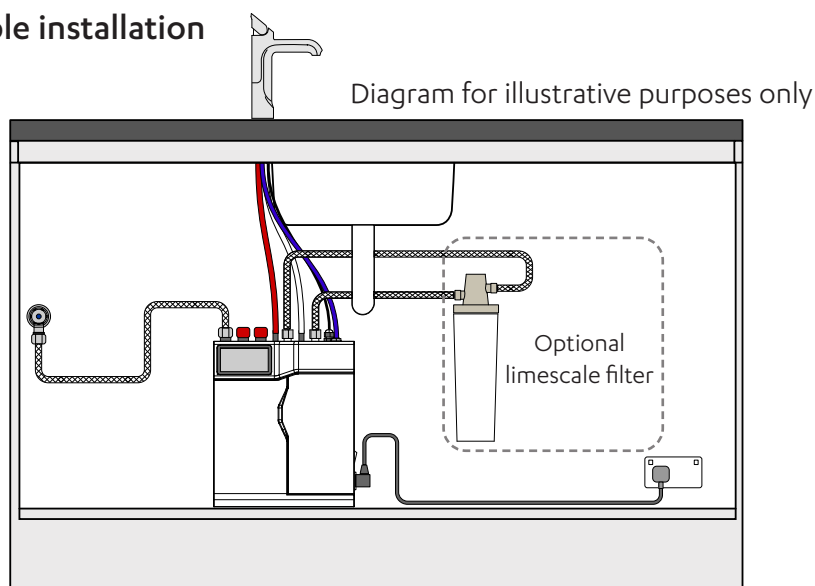

The HydroTap Clean process

HydroTap Clean is a first to market cleaning process for HydroTap systems comprised of the HydroTap Clean solution, dosing adaptor and smart firmware. The HydroTap Clean process is automated and gently cleans the chilled and sparkling water paths during the commissioning of a new HydroTap Command Centre.

The HydroTap Clean solution is:

Safe, natural, certified organic, PH neutral, biodegradable solution produced by electrochemically activated water acting like a detergent. HydroTap Clean is also non-corrosive to gently clean the chilled and sparkling internal water paths of your new HydroTap.

Parts supplied

Parts supplied with the HydroTap Clean kit	Qty
HydroTap Clean can adapter (1) (used in filter head)	1
HydroTap Clean can (2)	1
HydroTap Clean instructions	1

Parts identification



WARNING ! Do not connect the parts together before carefully reading/following instructions.

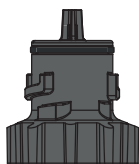

**HydroTap Clean
adapter (1)**



**HydroTap Clean
can (2)**



**HydroTap Clean
instructions**

SECTION 12: Commissioning

12. Commissioning the HydroTap using the HydroTap Clean can

12.1 Turn on the supplies & familiarise yourself with the system

- Connect the mains electrical power cable to the supply.
- Turn the power and water on and check for any leaks.
- Familiarise yourself with the operation of the tap and GUI screen in preparation for use, see the user guide.
- Initial commissioning screen touch Language option.

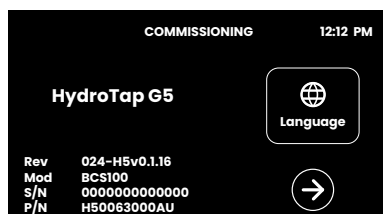

- Optional screen shown if the commissioning was previously started but not complete (Command Centre powered off during process). Otherwise screen will not be shown.

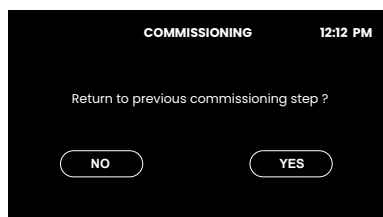

12.2 Select the language

- Touch the appropriate button to select the language and units of choice.
- Touch the back arrow to go back to previous menu.
- In the previous menu, touch the arrow to begin the commissioning process.
- Read the commissioning information, touch the forward arrow to go to the next screen.
- (Touch the back arrow to go back to previous menu).

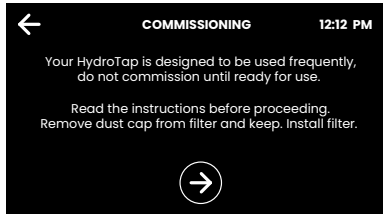
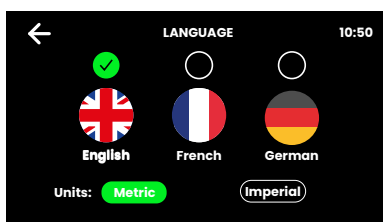

12.3 Install the filter cartridge

- Unpack filter cartridge.
- Remove dust cap and set aside in a clean area for use later.
- Write today's date where shown on the label.
- Avoid touching the filter o-rings and filter opening as this may cause bacterial contamination of the cartridge.
- Moisten the o-rings with water.
- Open the filter door on the Command Centre.
- Push the new cartridge up into the filter head.
- Turn the cartridge a quarter turn to the right until it comes to a complete stop and locks.

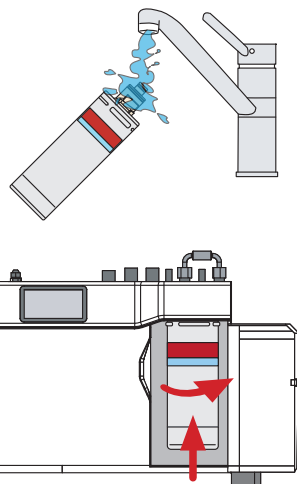

12.4 Set the date, time & drain away options

- Touch the date and time, use "-" or "+" to make adjustments. When ready, touch the arrow to continue.
- Select 'Sink / Container' or 'Font' depending on the model, see below.
- Select 'Font' if the HydroTap is mounted on a font.
- Select 'Sink / Container' if the HydroTap is mounted such that the waste water dispenses into a sink, or container.
- **Note** This selection will determine if water is dispensed automatically or requires operation of the tap during the tank flush process.
- Touch the arrow to continue.

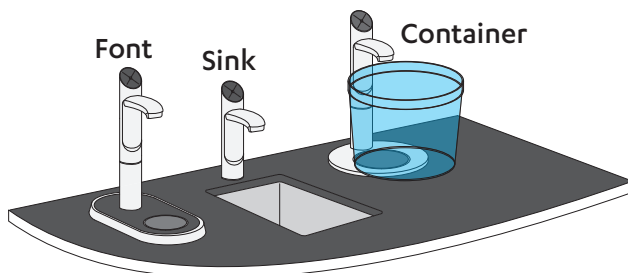
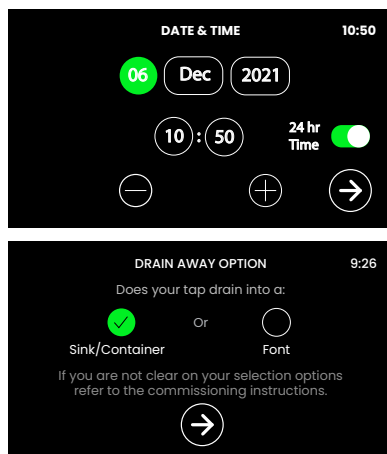

12.5 Filter flush

- Follow the steps on-screen to flush the filter.
- Open filter door & uncoil flush line.
- Direct flush line into bucket.
- Place a cloth or towel under the filter cartridge to catch any water that may spill.
- Open the stop cock valve.
- Start filter flush.

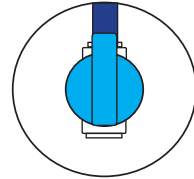
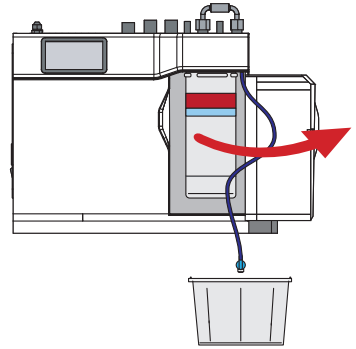

Stop cock valve open

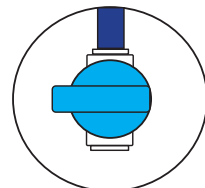
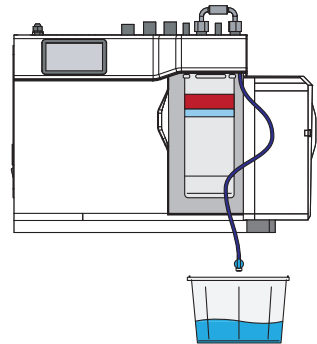

Stop cock valve closed

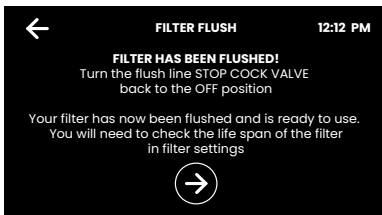
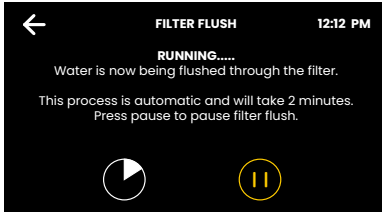
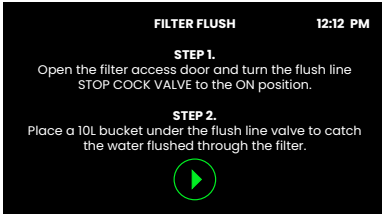

- Once the filter flush is finished, close the stop cock valve.
- Wipe up any spills.
- Close the door to secure the appliance.

SECTION 12: Commissioning

12.5.1 Limescale filter flush (If optional limescale filter is installed)

- Follow the steps on-screen.
- (Selecting NO advances the screen to the next process).

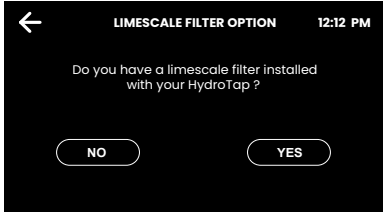

- Disconnect the limescale filter OUT hose from the Command Centre manifold.
- Direct it into a 15 litre container.
- Touch green play icon to start filter flush.

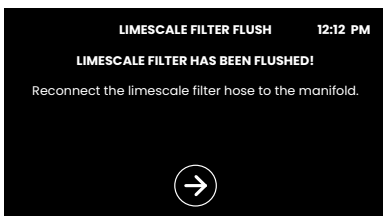
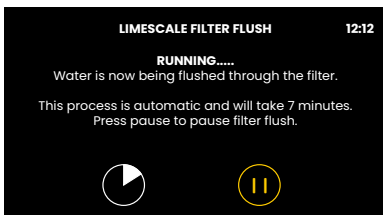
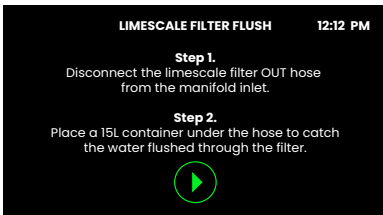

- Once the filter flush is finished, reconnect the limescale filter OUT hose to the Command Centre manifold.
- Touch the arrow to go to the next screen

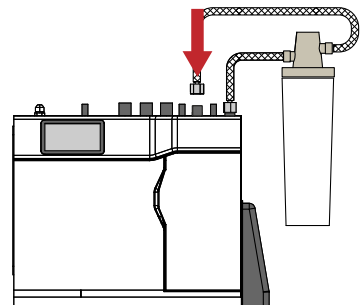
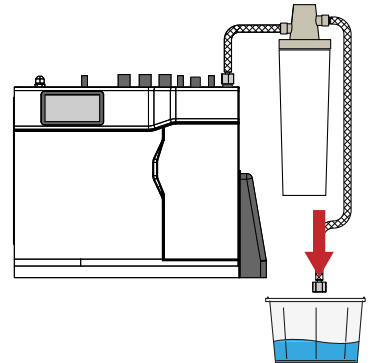
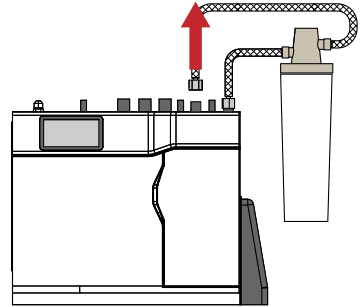

SECTION 12: Commissioning

12.6 System priming (BA models only)

- Read the on screen information.
- Touch the run arrow to go to the next screen.

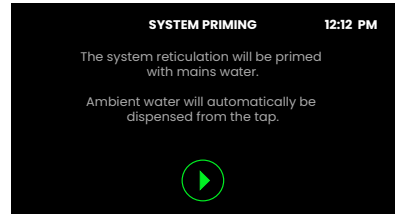

- Monitor the on screen information.

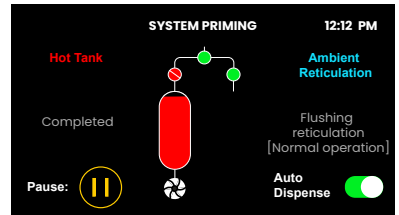

- **Note** if 'Font' has been selected on the drain away option (see section 12.4) and auto dispense is disabled on entry into this screen; the screen prompts the user to dispense using the tap during the process.

SECTION 12: Commissioning

12.7 Cleaning preparation (BA models only)

- Read the on screen information.



- Place a cloth under the filter.
- Remove the filter, refit the dust cap, and set aside in a clean environment.

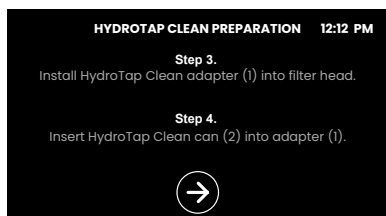
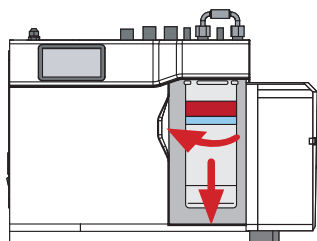

- Check the adapter seal is present and correctly positioned in the adapter.
- Install the HydroTap Clean adapter (1) into the filter head.
- Turn the adapter a quarter turn to the right until it comes to a stop and locks.

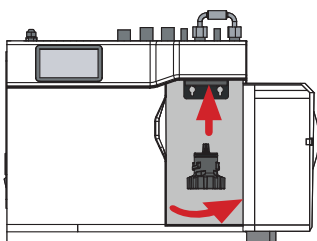
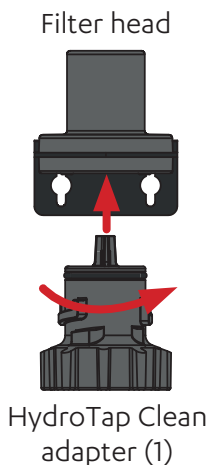

SECTION 12: Commissioning

- Remove the lid from the HydroTap Clean can (2).



HydroTap Clean can (2)

Filter head and HydroTap Clean adapter (1)

- Screw the HydroTap Clean can (2) into the adapter (already installed into the filter head).



HydroTap Clean can (2)

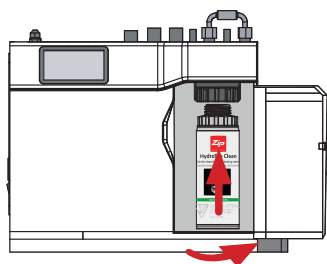

- Confirm installation of the HydroTap Clean can by selecting YES on the screen.



SECTION 12: Commissioning

12.8 Boiling calibration and cleaning

- Read the on screen information.
- This screen differs for different water types:
- B, just boiling calibration.
- BA, combined boiling calibration and cleaning.
- Touch the green arrow to run.

BA

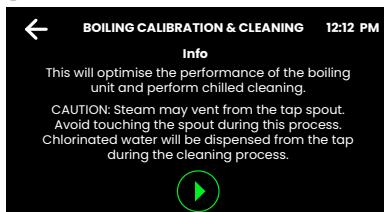

B

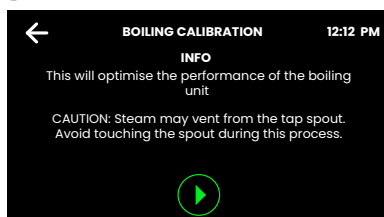

- Boiling calibration and cleaning process begins.
- Monitor the on screen information.
- Touch 'Cleaning' forward arrow to view screen of cleaning process.
- **Note** If 'Cleaning' text is flashing there is a required action on that screen to perform (empty cold tank).

BA

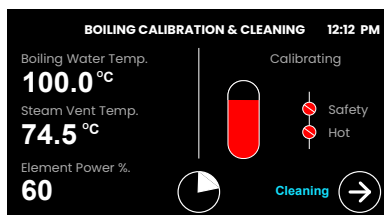

B

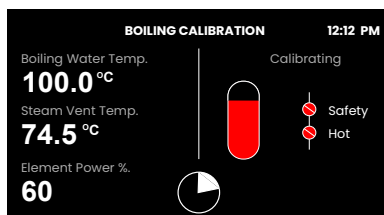

BA only

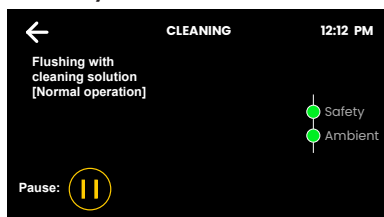

- Cleaning process begins. (BA only).
- Monitor the on screen information.
- **Note** This is automatic unless 'Font' was selected in the drain away option selection screen (see section 12.4). In this case a manual dispense action may be requested.

SECTION 12: Commissioning

- Read the on screen information and instructions.
- **Note** When the cleaning process completes there is an opportunity to re-install the filter while the boiling calibration is finishing.
- This screen is shown after completion of the boiling calibration and or cleaning processes.
- Unscrew the HydroTap Clean can (2).
- Ensure to hold the adapter in place while unscrewing the can.

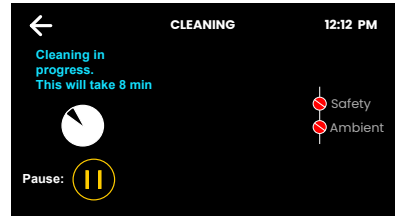

BA only



BA only

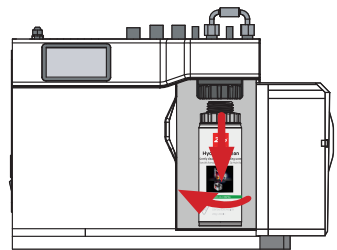
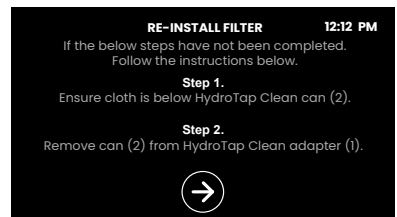

BA only

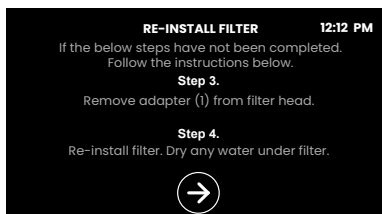

BA only

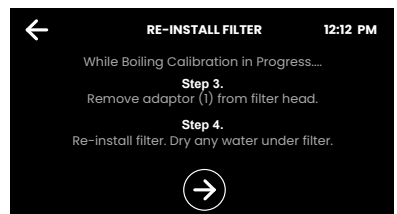

SECTION 12: Commissioning

- Remove the HydroTap Clean adapter (1) from filter head.

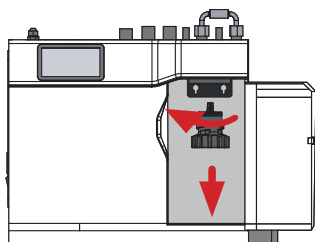

- Remove the dust cap and re-install the filter.
- Touch forward arrow on screen to continue.

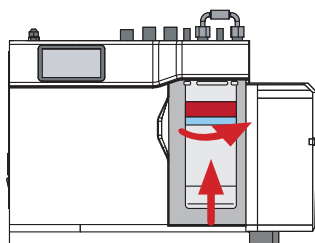

12.9 Tank flush

- Read the on screen information and instructions.
- Touch the green arrow to run.
- Empty the hot tank first (boiling models).
- Select NO if it is not safe to continue.
- Select YES to continue safely.
- If NO is selected (indicating that it is not safe to continue) the screen will prompt the user to clear the sink area.
- Once it is safe to continue select YES to empty the hot tank.

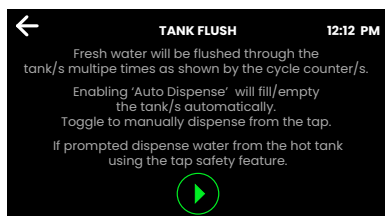

SECTION 12: Commissioning

- There are two ways to empty the hot tank:
- Dispense boiling water from the tap using the tap safety feature.

• OR

- Touch and **HOLD** the green run arrow icon to dispense directly from the touch screen display.
- If choosing to dispense directly from the touch screen display, 'dispensing boiling water' text flashes on the screen while holding the button.
- After the boiling tank is emptied the system progresses to the tank flush screen.
- **Note** For all models, the on screen cycle counter displays the number of remaining cycles in the tank flush process.

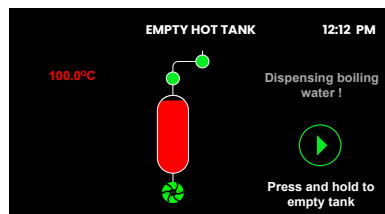
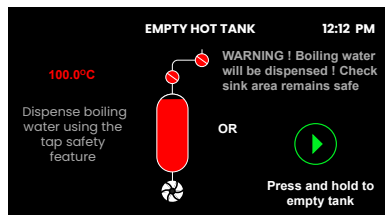

- **Note** For all boiling models, if after filling the hot tank during the tank flush process, the hot water temperature is still above 50°C the tank will need to be emptied again.
- Monitor the on screen information.
- For BA models the hot tank will cycle twice.
- The ambient water will be flushed for 30 seconds.

BA

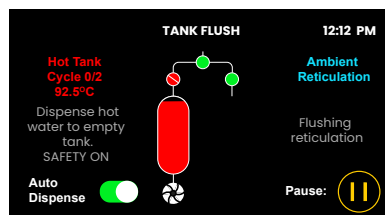

B

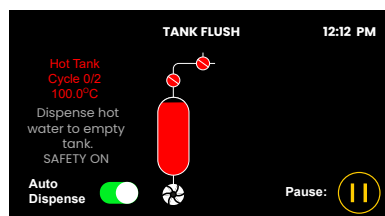

- Monitor the on screen information.
- For B models the hot tank will cycle twice.

12.10 Select the booster

- Read the on screen instructions.
- Select the appropriate option.
- BA, B: 100 & 30 models select Booster installed.
- All other models, Booster not installed.

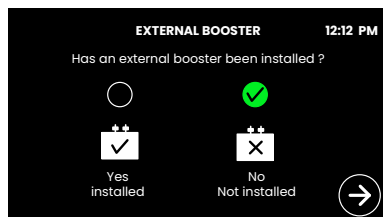

Safety sensor calibration (Classic boiling models only)

Optional, in cases where light recalibration is required.

Light intensity varies from site to site, therefore it is recommended that a re-calibration be performed at the time of the installation. All direct sunlight must be shaded from the HydroTap, during the calibration. This can be achieved by closing any nearby curtains, blinds, etc.

- Shield the HydroTap from direct sunlight.
- In normal operating mode. Turn the power off.
- Pull both tap levers to the forward position.
- Turn the power on.
- The safety sensor will calibrate.
- Return the levers to the neutral position.

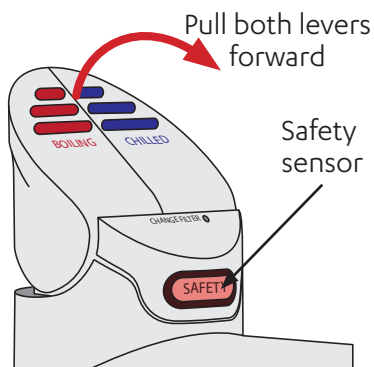

Refer to User Guide for operation and maintenance.



Zip Water

67 - 77 Allingham Street, Condell Park NSW 2200

Postal: Locked Bag 80, Bankstown 1885

Australia

Tel (+612) 9796 3100

Free call 1800 947 827 (1800 ZIP TAP)

www.zipwater.com



Zip Water UK

Trafalgar House, Rash's Green,

Dereham, Norfolk, NR19 1JG

0345 6 005 005

sales@zipindustries.co.uk

specify.zipwater.co.uk



As Zip policy is one of continuous product improvement, changes to specifications may be made without prior notice. Images in this booklet have been modified and may not be true representations of the finished goods.

The terms "Zip" and "HydroTap" are registered trade marks of Zip Heaters (Aust) Pty Ltd.